

FLOOR PLAN NOTES

PROVIDE EMERGENCY EGRESS WINDOWS WITH MINIMUM NET CLEAR OPENABLE AREA OF 5.7 SQUARE FEET. DIMENSIONS SHALL BE 24" MIN. HIGH BY 20" MIN. WIDE, WITH A MAXIMUM FINISH SILL HEIGHT OF 44" ABOVE THE SUBFLOOR. C.R.C.

GLAZING SUBJECT TO HUMAN IMPACT SHALL BE TEMPERED, LABELED "SAFETY GLASS", AND COMPLY WITH C.R.C. AS FOLLOWS:

- GLAZING IN DOORS AND ENCLOSURES FOR HOT TUBS, WHIRLPOOLS, SAUNAS, STEAM ROOMS, BATHTUBS, SHOWERS, AND GLAZING IN ANY PORTION OF A WALL ENCLOSING THESE COMPARTMENTS WHERE THE BOTTOM EXPOSED EDGE OF THE GLAZING IS LESS THAN 60" ABOVE A STANDING SURFACE AND DRAIN INLET.

- GLAZING IN FIXED OR OPERABLE PANELS ADJACENT TO A DOOR WHERE THE NEAREST EXPOSED EDGE OF THE GLAZING IS WITHIN A 24" ARC OF EITHER VERTICAL EDGE OF THE DOOR IN A CLOSED POSITION AND WHERE THE BOTTOM EXPOSED EDGE OF THE GLAZING IS LESS THAN 60" ABOVE THE WALKING SURFACE.

- GLAZING IN INDIVIDUALLY FIXED OR OPERABLE PANELS (OTHER THAN ABOVE) THAT MEET ALL OF THE FOLLOWING CONDITIONS: GLAZING GREATER THAN 9 SQ. FT. IN AREA; BOTTOM EXPOSED EDGE LESS THAN 18" & TOP EXPOSED EDGE GREATER THAN 36" ABOVE THE FLOOR; AND WITHIN 36" HORIZONTALLY OF ANY WALKING SURFACE.

SLIDING GLASS WINDOWS SHALL BE DESIGNED AND INSTALLED SO AS TO PREVENT THEIR REMOVAL BY RAISING THE MOVABLE PANEL FROM THE TRACK WHILE IN THE CLOSED POSITION. SLIDING UNITS SHALL ALSO HAVE AN APPROVED PRIMARY AND AUXILIARY LOCKING DEVICE PERMANENTLY MOUNTED AND NOT ACCESSIBLE FROM THE EXTERIOR OF THE BUILDING. THE MOVABLE SECTION OF THE SLIDING UNITS SHALL BE MOUNTED ON THE INSIDE TRACK.

ALL DOORS AND WINDOWS ARE TO BE FULLY WEATHER-STRIPPED PER TITLE 24 REQUIREMENTS.

ALL JOINTS AND PENETRATIONS ARE TO BE PROPERLY CAULKED AND SEALED PER TITLE 24 REQUIREMENTS.

PROVIDE 26 GA. GI. FLASHING AT ALL NEW CONCRETE PORCH/STOOP AREAS WHERE CONTACT WITH WOOD FRAMING WILL OCCUR.

ALL STEPS AND STAIRWAYS RISERS SHALL NOT BE LESS THAN 4" MIN. OR GREATER THAN 7.75" MAX. ALL TREADS SHALL BE 13" WIDE (BUT, NOT LESS THAN 9" MIN.) TYPICAL UNLESS NOTED OTHERWISE ON THE PLANS. C.R.C.

SHOWER AND TUB WALLS SHALL BE FINISHED WITH A NON-ABSORBENT SURFACE, SUCH AS TILE OR OTHER APPROVED MATERIAL, TO A MINIMUM HEIGHT OF 72" ABOVE THE DRAIN INLET. APPLY NON-ABSORBENT MATERIAL TO WATER-PROOF BUILDING PAPER AND WIRE LATH, INSTALLED OVER WATER-RESISTANT GYP. BOARD APPLIED DIRECTLY TO STUDS. C.R.C.

PROVIDE MIN. 24" CLEAR AT FRONT AND MIN. 30" CLEAR WIDTH AT ALL WATER CLOSETS.

SEISMIC STRAP WATER HEATER TO BUILDING AND INSTALL A MIN. R-12 INSULATION BLANKET. C.P.C. SECTION 510.5, & TITLE 24 REQUIREMENTS.

EXHAUST FANS IN BATHROOMS, LAUNDRY ROOMS, AND SIMILAR ROOMS SHALL BE VENTED DIRECTLY TO THE OUTSIDE AND CAPABLE OF PROVIDING A MINIMUM OF FIVE COMPLETE AIR CHANGES PER HOUR. C.R.C.

MECHANICAL AND PLUMBING PENETRATIONS PASSING ENTIRELY THROUGH BOTH PROTECTIVE MEMBRANES OF BEARING WALLS REQUIRED TO HAVE A FIRE-RESISTANCE RATING, AND WALLS REQUIRING PROTECTED OPENINGS SHALL BE PROTECTED WITH THROUGH-PENETRATION FIRE BLOCKS SUITABLE FOR THE METHOD OF PENETRATION. PER C.R.C.

PROVIDE FIREBLOCKING IN THE FOLLOWING LOCATIONS PER C.R.C.

(A) IN CONCEALED SPACES OF STUD WALLS AND PARTITIONS, INCLUDING FURRED SPACES, AT THE CEILING AND FLOOR LEVELS AND AT 10 FT. INTERVALS BOTH VERTICAL AND HORIZONTAL.

(B) AT ALL INTERCONNECTIONS BETWEEN CONCEALED VERTICAL AND HORIZONTAL SPACES SUCH AS OCCUR AT SOFFITS, DROP CEILING, AND COVE CEILING.

(C) IN CONCEALED SPACES BETWEEN STAIR STRINGERS AT THE TOP AND BOTTOM OF THE RUN, AND BETWEEN STUDS ALONG AND IN LINE WITH THE RUN OF THE STAIRS IF THE WALLS UNDER THE STAIRS ARE UNFINISHED.

(D) IN OPENINGS AROUND VENTS, PIPES, DUCTS, CHIMNEYS, FIREPLACES AND SIMILAR OPENINGS AT CEILING AND FLOOR LEVELS, WITH NON-COMBUSTIBLE MATERIALS.

(E) AT OPENINGS BETWEEN ATTIC SPACES & CHIMNEY CHASES FOR FACTORY-BUILT CHIMNEYS.

5/8" TYPE 'X' ONE HOUR FIRE RATED GYP. BOARD SHALL BE INSTALLED ON ALL WALLS AND CEILING AT GARAGE SIDE WHICH ARE COMMON TO ANY LIVING AREAS, ALSO INSTALL FIRE RATED GYPSUM BOARD AT UNDERSIDE OF ANY ENCLOSED STAIRWAYS. PER C.R.C.

ANY INSTALLED GAS FIREPLACE SHALL BE A DIRECT-VENT SEALED-COMBUSTION TYPE. ANY INSTALLED WOODSTOVE OR PELLET STOVE SHALL COMPLY WITH US EPA PHASE II EMISSION LIMITS WHERE APPLICABLE. WOODSTOVE, PELLET STOVES AND FIREPLACES SHALL ALSO COMPLY WITH APPLICABLE LOCAL ORDINANCES.

CARPET AND CARPET SYSTEMS SHALL BE COMPLIANT WITH VOC LIMITS.

80 PERCENT OF FLOOR AREA RECEIVING RESILIENT FLOORING SHALL COMPLY WITH THE VOC-EMISSION LIMITS DEFINED IN THE COLLABORATIVE FOR HIGH PERFORMANCE SCHOOLS (CHIPS), HIGH PERFORMANCE PRODUCTS DATABASE OR BE CERTIFIED UNDER THE RESILIENT FLOOR COVERING INSTITUTE (FRCI) FLOORSCORE PROGRAM; OR MEET CALIFORNIA DEPARTMENT OF PUBLIC HEALTH SPECIFICATION 01350.

PARTICLEBOARD, MEDIUM DENSITY FIBERBOARD (MDF) AND HARDWOOD PLYWOOD USED IN INTERIOR FINISH SYSTEMS SHALL COMPLY WITH LOW FORMALDEHYDE EMISSION STANDARDS.

VAPOR RETARDER AND CAPILLARY BREAK IS INSTALLED AT SLAB-ON-GRADE FOUNDATIONS.

SHOWER AND OR TUB/SHOWER WALLS SHALL HAVE A SMOOTH, HARD, NOABSORBENT SURFACE (E.G. CERAMIC TILE, FIBERGLASS ECT.) OVER MOISTURE RESISTANT UNDERLAYMENT (E.G. WATER RESISTANT GYPSUM BOARD, GREEN BOARD ECT.) TO A HEIGHT OF NOT LESS THAN 6" ABOVE THE FLOOR. PER C.R.C. 307.2, R702.4 AND R702.3.7

ALL EGRESS DOORS SHALL BE READILY OPENABLE FROM THE INSIDE WITHOUT THE USE OF A KEY OR SPECIAL KNOWLEDGE OR EFFORT. PER C.R.C. SECTION R311.2

ALL EXTERIOR WINDOWS AND SLIDING DOORS SHALL BE TESTED BY AN APPROVED INDEPENDENT LABORATORY, AND BEAR A LABEL IDENTIFYING MANUFACTURE, PERFORMANCE CHARACTERISTICS AND APPROVED INSPECTION AGENCY TO INDICATE COMPLIANCE WITH AAMA/WDMA/CSA 101/1.5.2/A440

EXTERIOR SIDED-HINGED DOORS SHALL BE TESTED AND LABELED AS CONFORMING TO AAMA/WDMA/CSA 101/1.5.2/A440 OR COMPLY WITH SECTION R609.1 AND R609.3 OR COMPLY WITH C.R.C. SECTION R609.

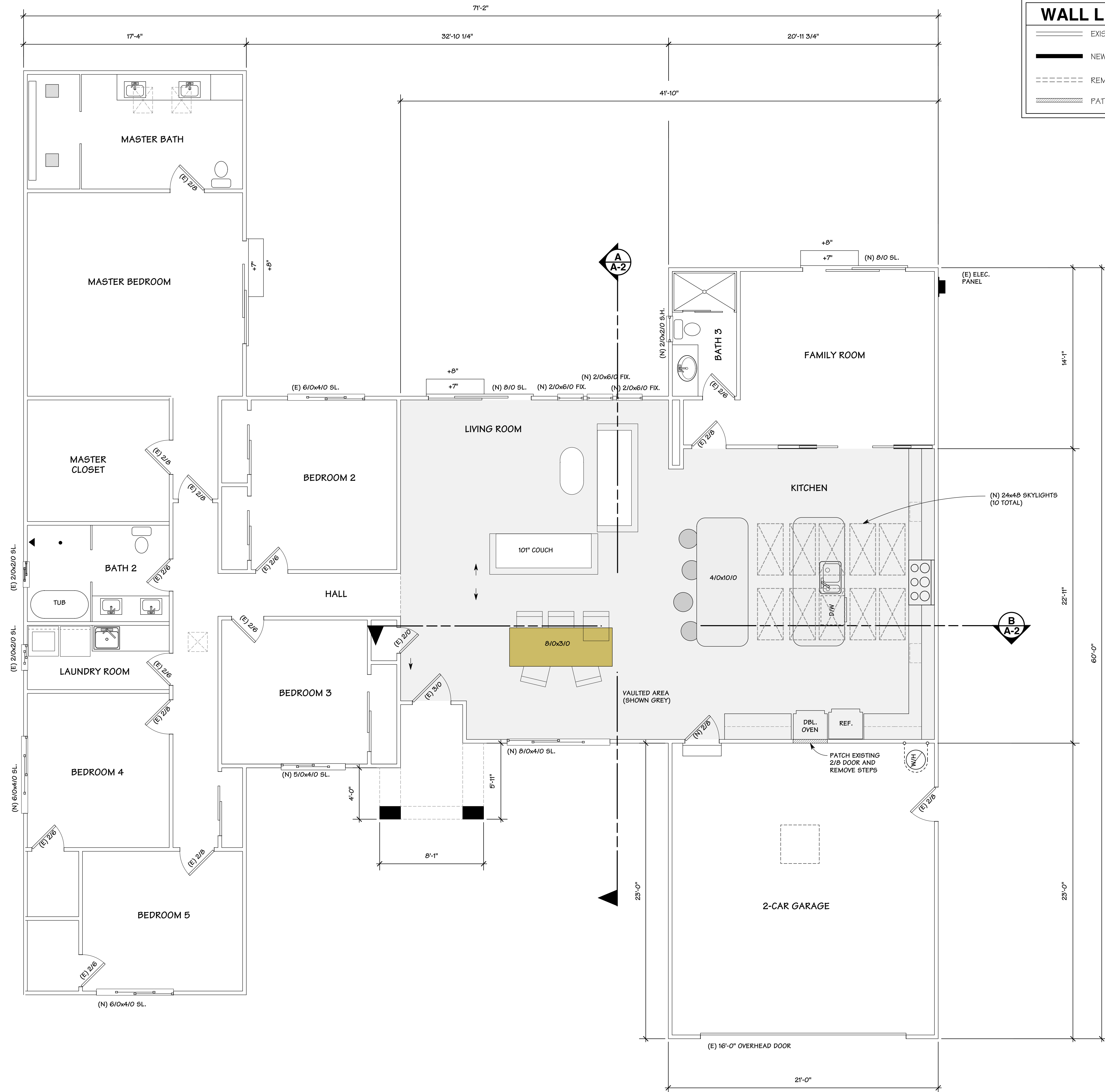

WALL LEGEND

- EXISTING WALL
- NEW WALL
- REMOVE WALL
- PATCH / CLOSE WALL

PROPOSED FLOOR PLAN

SCALE: 1/4" = 1'-0"

OWNER: MR. AND MRS. ALEVIZOS
1137 VIA JOSE
SAN JOSE, CA. 95120

DESIGN BY: PACIFIC BLUE DEVELOPMENTS
Michael S. Radu
1000
Cambridge, CA. 95008
(408) 504-6826 Cell

REVISION:

PROPOSED FLOOR PLAN PLAN NOTES

DRAWN BY: Michael S. Radu

CHECKED BY: PBD

JOB NO.: 21-13

DATE: 01/24/2022

SCALE: AS SHOWN

SHEET: A-4